

MP/S angles are field-adjustable to attach members intersecting at angles. MP/S angles are load rated and provide adequate thickness and fastener quantity to the field fabricated clip angles.

Features:

- Field adjustable from 0° to 135°.
- For new construction and retrofit applications for steel-to-steel connections.

Materials: 18 gauge

Finish: G90 galvanizing

Installation:

- Use all specified fasteners.
- Field-adjustable from 0°-135°. Bend angle only once.
- Joist must be constrained from rotation.

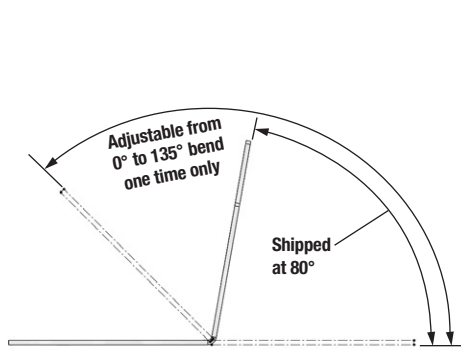
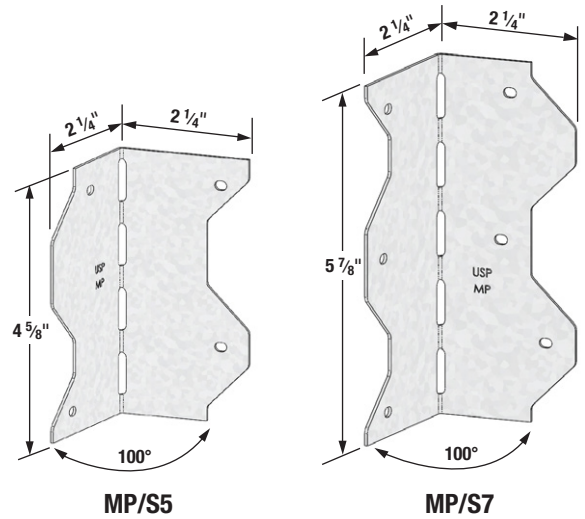

MP/S Top View

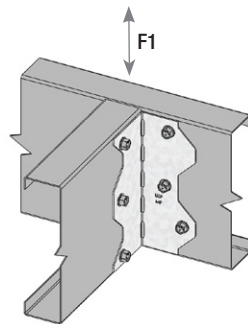

Typical MP/S7 installation (MP/S5 similar)

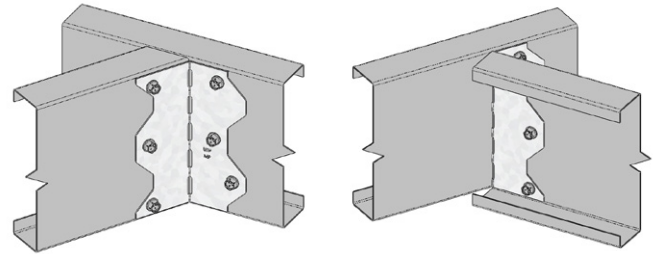

Typical MP/S7 skew installation (MP/S5 similar)

USP Stock No.	Ref. No.	Steel Gauge	Fastener Schedule		Supporting & Supported Member ¹	Allowable Loads ³	Ctn Qty
			Qty	Type ²			
MP/S5	S/LS50	18	4	#10	Mills 33	F1 310	100
					Mills 43	F1 410	
					Mills 54	F1 480	
MP/S7	S/LS70	18	6	#10	Mills 33	F1 405	50
					Mills 43	F1 640	
					Mills 54	F1 745	

1) Member Mills (33, 43, 54) has been considered as Grade 33.

2) #10 self tapping screws are considered to fully penetrate all members.

Screws are to be "Hex Head", unless approved.

#10 self tapping screws are 0.190" dia. and 0.340" head

3) Allowable loads are for one part only.